

3909/500 Pacific Highway St Leonards, NSW

 2
  2
  1

Resort Style Two Bedroom with Harbour Bridge Views

Experience the breath taking beauty of Sydney's renowned Harbour Bridge and cityscape from the comfort of your private sanctuary at the Landmark residence, where luxury and serenity converge.

Elevated to capture a 270-degree panoramic view, indulge in world-class scenery from your expansive wrap-around balcony, seamlessly extending the spectacle into your living space. This waterfront lifestyle retreat amidst the bustling metropolis offers proximity to both nature and urban allure.

Home Features:

Contact Agent

Inspect : Saturday, 11th May 2024 12:30 - 1:00
Type : Apartment
Land : 133 m2
Building Size : 117 m2

Council Rates : \$373.00 p/q
Water Rates : \$224.00 p/q
Strata Rates : \$2,012.45 p/q

Jeffrey Li
0404 135 763

Sue Tsui
0455141685

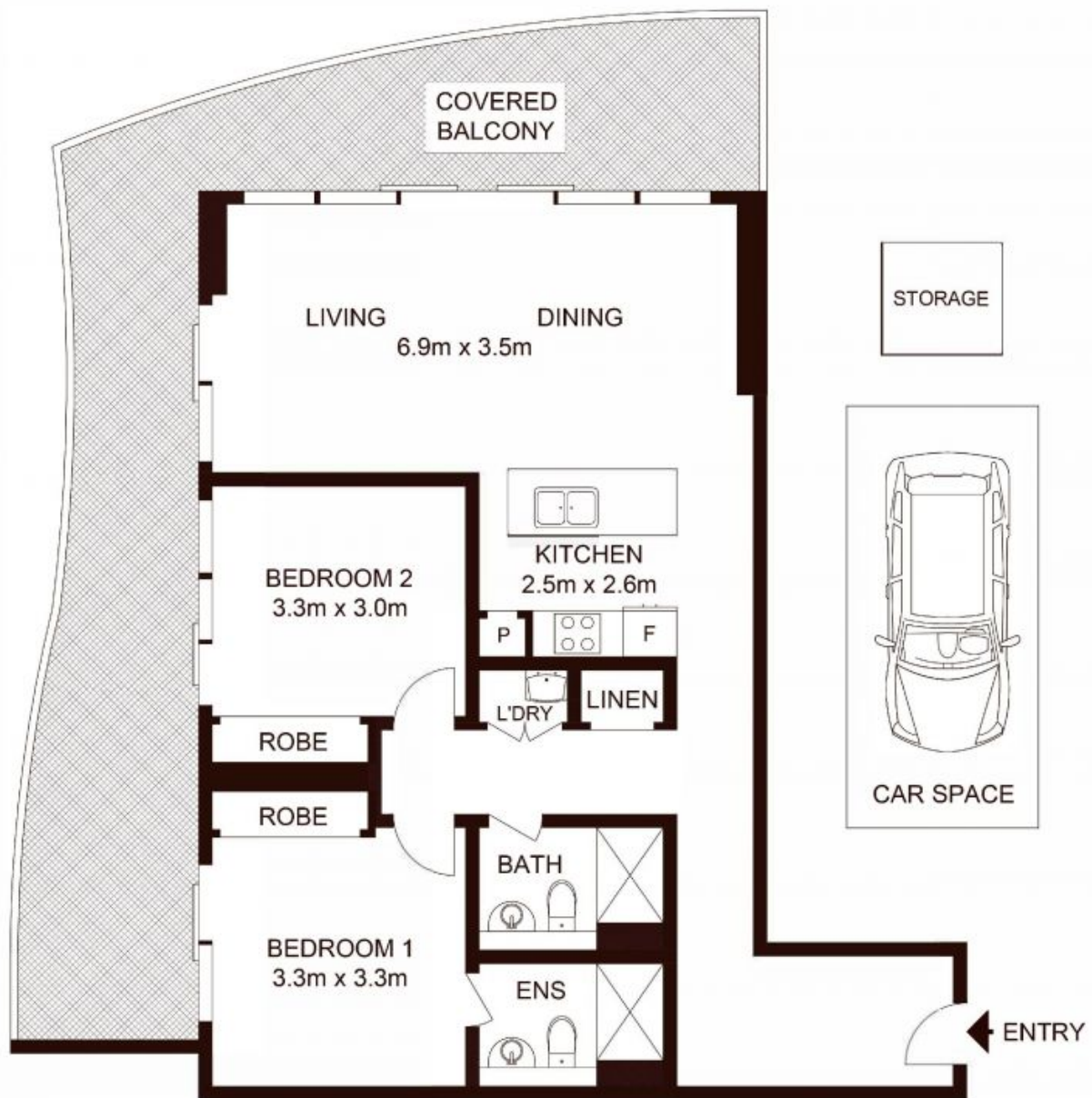

LEVEL 39

TOTAL LIVING AREA: 117m²
 TOTAL STRATA AREA: 133m²

3909/500 Pacific Highway, ST LEONARDS

Not to scale • All measurements are approximate • Drawn for marketing purposes only • Floorplan by © Xorix Media

