

510/500 Pacific Highway St Leonards, NSW



1



1

Luxury studio with Terrace in 'Landmark'

This premium studio apartment is ideal as a first home or for an astute investor considering its blue-chip location, the surrounding local amenity, connectivity and the design and craftsmanship of the development.

This stunning studio apartment in the 'Landmark' presents the trio of high quality design and finish, a clever floorplan that maximises space of external living area. Open floor plan and high-end finishes creating a modern look. Floor to ceiling thermal glass windows, large balconies, and kitted out kitchen with Miele appliances

Home Features:

- Open plan living and dining area with access to the balcony
- Timber floor throughout the apartment

\$765,000

Inspect : Saturday, 11th May 2024 1:00 - 1:30
Type : Apartment
Land : 75 m2
Building Size : 73 m2

Council Rates : \$373.00 p/q
Water Rates : \$189.14 p/q
Strata Rates : \$771.60 p/q

Jeffrey Li

0404 135 763

Faye Dai

0423 677 160

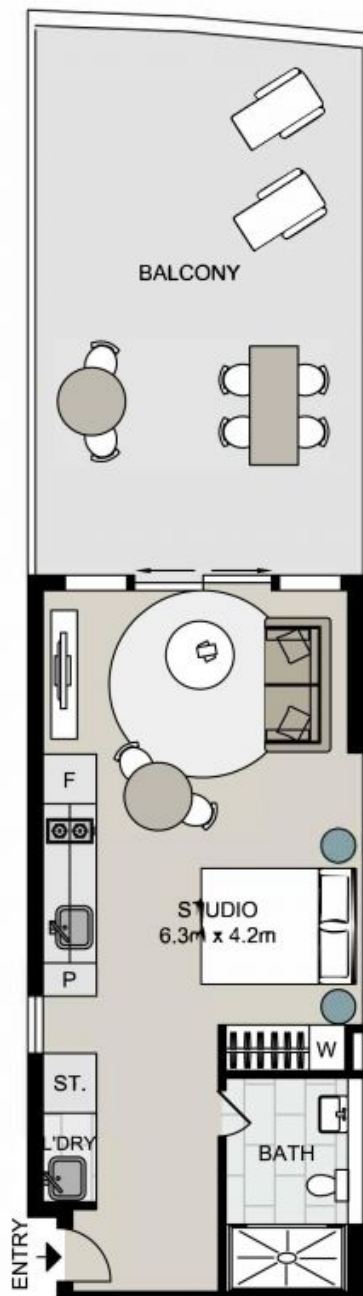

Total living area: 73sqm
Total strata area: 75sqm

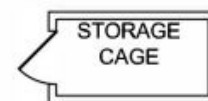

510/500 Pacific Highway, ST LEONARDS

Not to scale . Measurements are approximate . Drawn For Marketing purposes only .

