



22/15-19 Havilah Road Lindfield, NSW

 1
  1
  1

## Spacious & North Facing One bedroom plus study in the Heart of Lindfield

Attractive interiors feature stylish finishes throughout that lend a designer touch making it immediately ready to enjoy. Its bright, sophisticated design boasts a separate study if you'd like to work from home, while luxurious dimensions with high-end finishes deliver optimal functionality for daily ease of living.

Home features:

- \* Timber floors, high ceilings, superb light-filled interiors
- \* Bright north-facing aspect
- \* ??Generous open plan living and dining, leafy green outlook
- \* ??Large sliders lead to an alfresco entertaining balcony
- \* ??Gourmet stone-topped kitchen, gas cooking, dishwasher
- \* ??Ducted a/c, European style laundry

## Contact agent

**Type** : Unit  
**Sold Date** : Tuesday, 21st November 2023  
**Land** : 77 m2  
**Building Size** : 63 m2

**Council Rates** : \$358.00 p/q  
**Water Rates** : \$173.29 p/q  
**Strata Rates** : \$1,099.87 p/q

**Jeffrey Li**

0404 135 763

**Reika Morikawa**

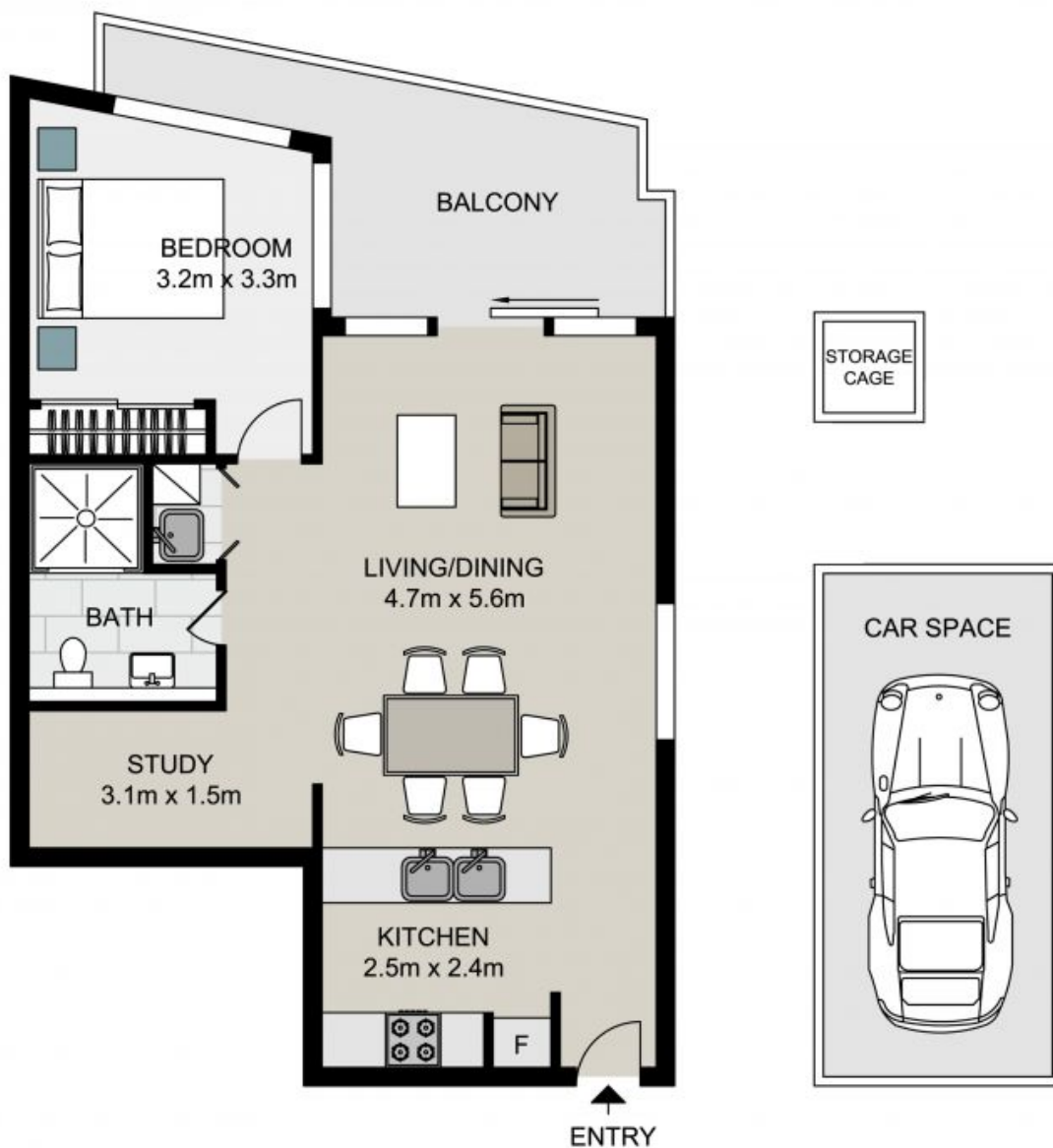

TOTAL LIVING AREA: 63sqm  
 TOTAL STRATA AREA: 77sqm

22/15-19 Havilah Road, LINDFIELD

Not to scale . Measurements are approximate . Drawn For Marketing purposes only .

