



1302/472 Pacific Highway St Leonards, NSW

 1
  1
  1

St Leonards CBD | Rare Car Space+Storage | Mirvac Built

St Leonards Square exemplifies Mirvac's reputation for sophisticated living in Sydney. With superb amenities, exceptional harbour and city views and a vibrant ground-floor plaza, this is an iconic destination that will define St Leonards for years to come.

Apartment Features:

- Large-sized bedroom, complete with built-ins (Master with ensuite)
- Functional layout and wonderful set up one bedroom located in the William tower
- Gourmet kitchen with tinted splashback and Miele appliances
- Tiled kitchen and living area with wool carpet within the bedroom
- Luxurious bathroom with Car space and storage space

Contact Agent

Type : Apartment

Council Rates : \$376.20 p/q

Water Rates : \$210.16 p/q

Strata Rates : \$965.20 p/q

Jeffrey Li

0404 135 763

Faye Dai

0423 677 160

TOTAL LIVING AREA: 60sqm
TOTAL STRATA AREA: 78sqm

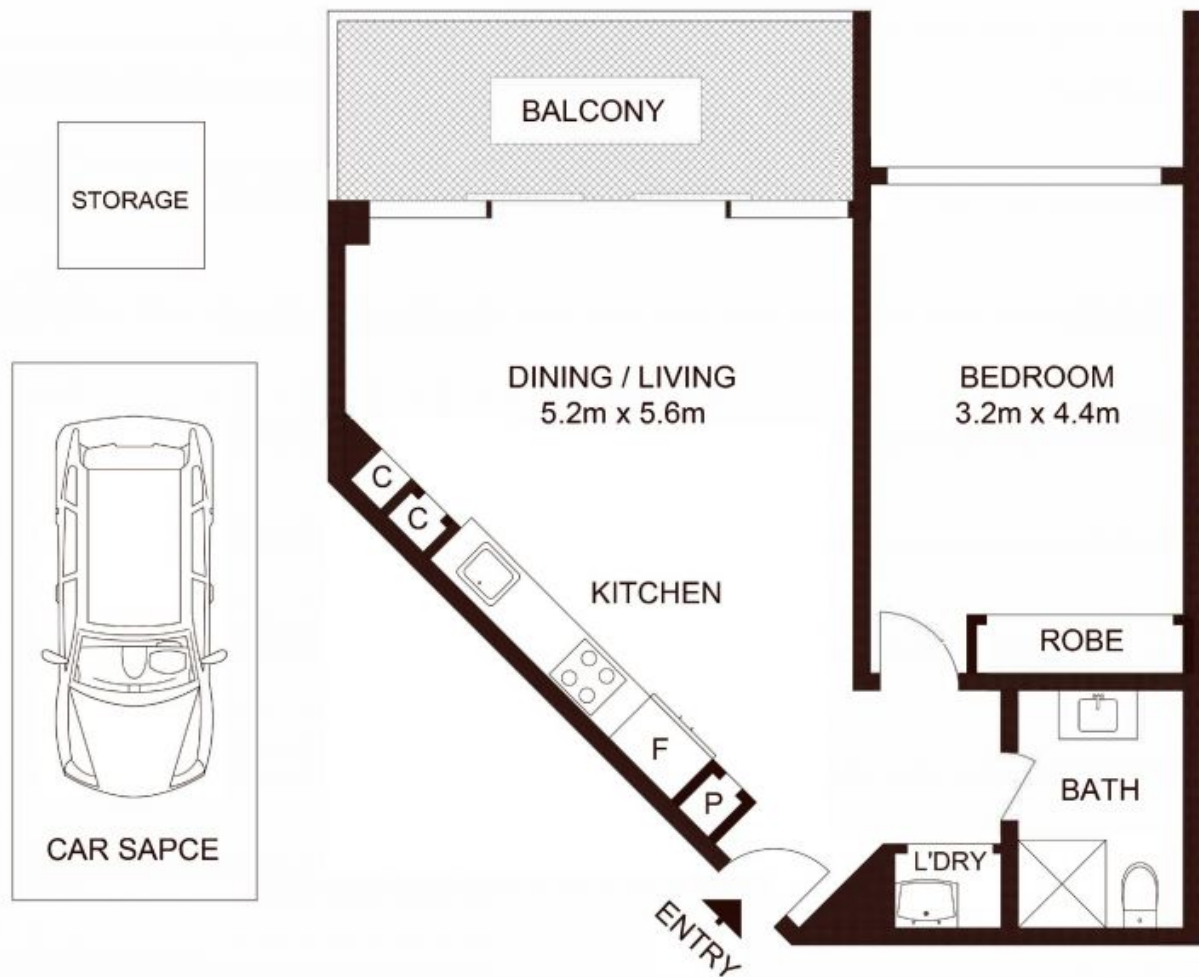

1302/472 Pacific Highway, ST LEONARDS

Not to scale • All measurements are approximate • Drawn for marketing purposes only • Floorplan by © Xorix Media

