



2903/117 Bathurst Street Sydney, NSW

 2  2  1

Oversized 2 bedroom apartment in the heart of Sydney CBD

Centrally located in the heart of Sydney CBD, this modern apartment offers the perfect balance of luxury and convenience. The Greenland Centre, designed by the acclaimed architects, BVN and Woods Bagot, sets a new benchmark of luxury and convenience in residential city living, characterized by elegant living spaces and a fastidious attention to detail.

Home features:

- Corner position north & east facing
- Floor-to-ceiling glass walls
- Generous open-plan living and dining area flowing to balcony
- Marble benchtops and premium quality cabinetry
- Reverse-cycle, ducted air conditioning
- Immediate access to Hyde Park, Royal Botanic Gardens Sydney, Australian Museum, Art Gall

Contact Agent

Type : Apartment
Land : 100 m2
Building Size : 99 m2

Council Rates : \$320.06 p/q
Water Rates : \$180.38 p/q
Strata Rates : \$1,468.00 p/q

Jeffrey Li

0404 135 763

Reika Morikawa

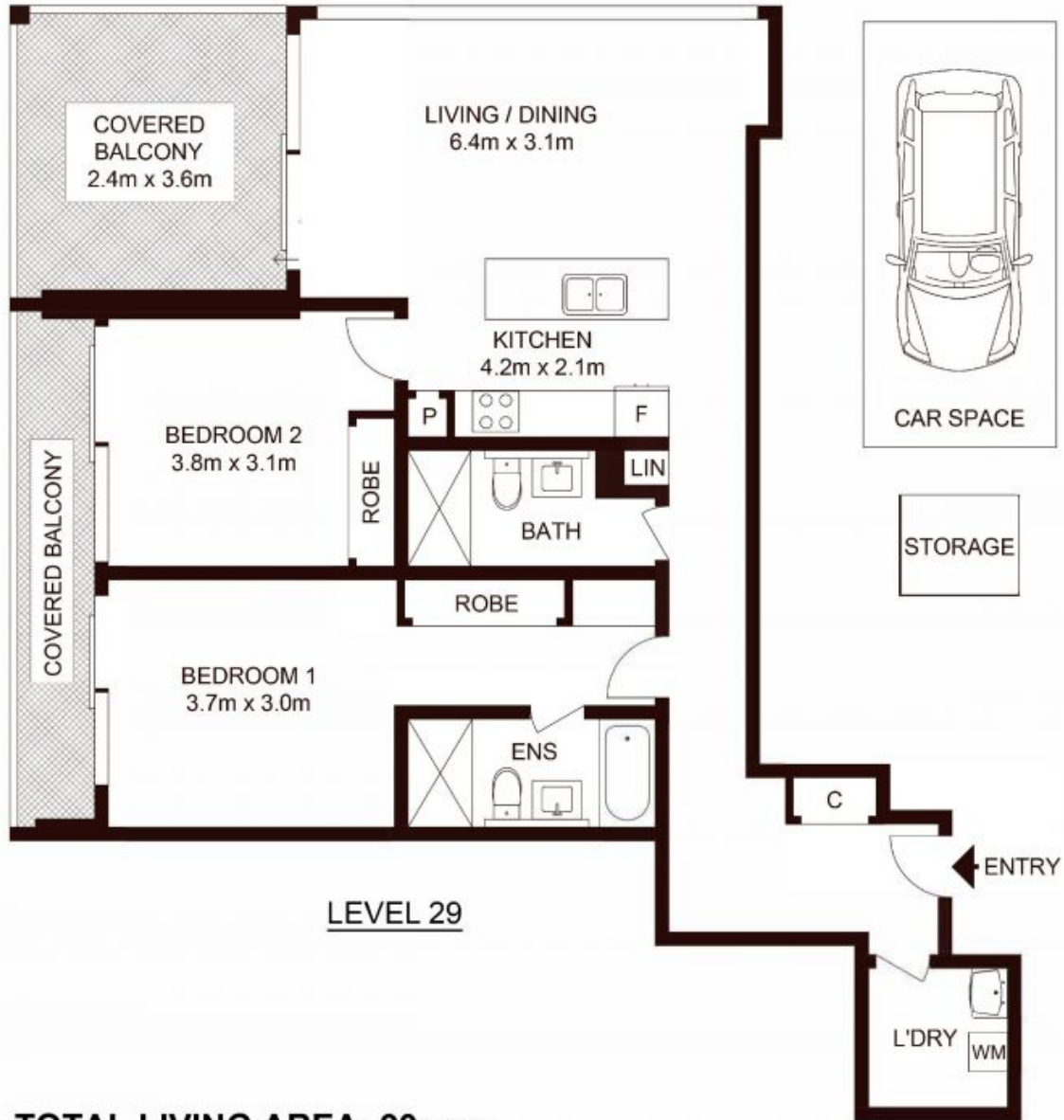

TOTAL LIVING AREA: 99sqm
TOTAL STRATA AREA: 100sqm

2903/117 Bathurst Street, SYDNEY

Not to scale • All measurements are approximate • Drawn for marketing purposes only • Floorplan by © Xorix Media

