



1208/472 Pacific Highway St Leonards, NSW

 2
  2
  1

## Sun-drenched northeast delight in Mirvac

Designed for immaculate contemporary living and open plan in/outdoor entertaining, this northeast apartment boasts enviable resort-style living in the new 'St Leonards Square' building. Quality appointments ensure there's nothing to spend and everything to enjoy. The building promotes an active lifestyle with a shared indoor lap pool, gym, spa, sauna, function rooms and terrace.

### Home Features:

- Open plan kitchen, living/dining flow to covered balcony
- Stone bench tops and gas stainless steel Miele appliances
- Generous bedrooms with built-in robes, one with an ensuite
- Internal laundry, ducted air conditioning, security entrance
- Stroll to the heart of Crows Nest village eateries and nightlife

**Type** : Apartment  
**Sold Date** : Monday, 7th November 2022

**Council Rates** : \$352.00 p/q  
**Water Rates** : \$160.18 p/q  
**Strata Rates** : \$1,292.22 p/q

**Jeffrey Li**  
 0404 135 763

**Faye Dai**  
 0423 677 160

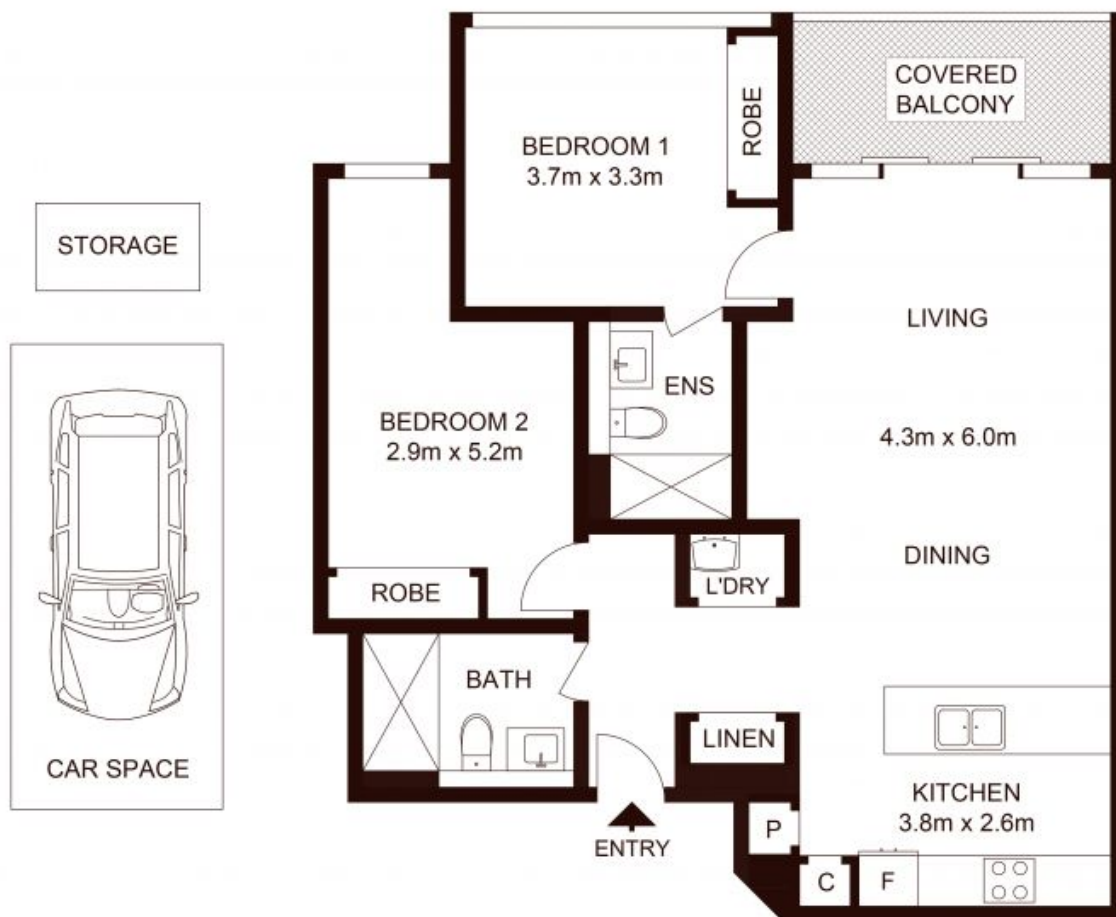

LEVEL 12

TOTAL STRATA : 104m<sup>2</sup>  
TOTAL LIVING AREA : 84m<sup>2</sup>

1208/472 Pacific Hallway, ST LEONARDS

Not to scale • All measurements are approximate • Drawn for marketing purposes only • Floorplan by © Xorix Media

