



Level 2/71 Military Road Neutral Bay, NSW

 2  1

Spacious two-bedroom with full floor living area in Neutral Bay-Enter from rear

Modern spacious two-bedroom apartment located at the rear of the building which bedroom is peaceful and quiet in the centre convenient location. A short walk to the express bus stop to Sydney CBD, North Sydney and Chatswood, shops, cafes, supermarkets, restaurants.

Featuring:

- * Open plan living area - on the second floor
- * North-facing; strong natural light
- * Bathroom with bath, shower & WC
- * Internal laundry & washing machine included
- * Spacious small back yard
- * Off-street parking only
- * Rear of the block

Deposit Taken

Type : Apartment
Date Available : Saturday, 13th March 2021
Building Size : 80 m2

Jeffrey Li
 0404 135 763

Tiffany Or
 0455582288

FLOOR PLAN



FIRST FLOOR

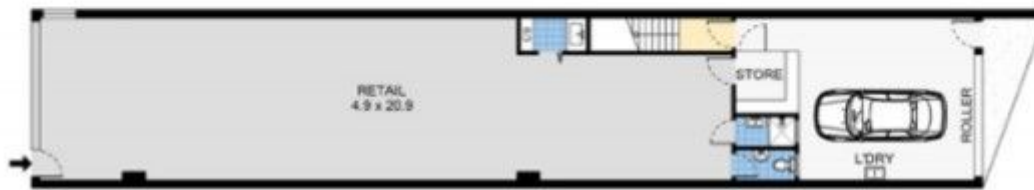

GROUND LEVEL